

**Description:**

Directional HO Surface Mount Spotlight, 9Watt Bridgelux V8 Gen-7, Various colour temperatures, beam angles and finishes. Machined solid brass or Machined Aluminium 6061 body, Borosilicate Glass Lens, pre-fitted Honey Comb Baffle, Resin Sealed Cable Gland, Stainless Steel hinge Screws, pre-fitted Double insulated exterior rated cable, Surface mount bracket for gardens. IP67.

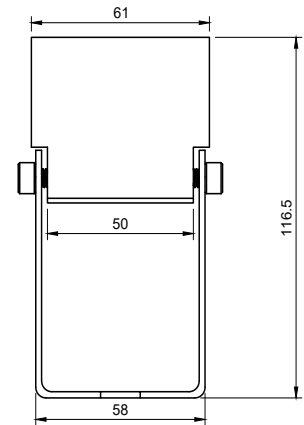
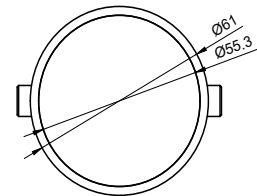

**Technical:**

LED TYPE	Bridgelux V8 Gen-7	CONTROL GEAR	REMOTE
RATED POWER	9W	DIMMING PROTOCOL	DALI - 0-10V - PHASE DIM - ON/OFF
CRI	80	CABLE LENGTH	500MM STANDARD LENGTH
BEAM ANGLES	NOMINATED IN TABLE BELOW	MOUNTING OPTIONS	SURFACE/ SPIKE
INPUT POWER / FORWARD VOLTAGE	350mA / 18V DC	WEIGHT	0.8KG
NOMINAL LUMENS	1485lm	HARDWARE	GLASS LENS, O-RING, GLAND, CABLE
IP RATING	IP65	CONSTRUCTION	MACHINED METAL & HEATSINK
COLOUR TEMPERATURE	2700K - 3000K - 4000K	WARRANTY	2 YEARS

**Product Generator:** example 1606-AB-M-30-S-9W-4-1

Model	Finish	Beam Angle	CCT	Mounting	Wattage	Dimming	Accessory
NL1606	AB Aged Brass	N Narrow 16°	27 2700K	S Surface	9W / 350mA	1 DALI	1 Honeycomb Louver
	BR Brushed Brass	M Medium 22°	30 3000K			2 0-10V	2 Diffuser Lens
	SS Stainless Steel	W Wide 33°	40 4000K			3 Phase	3 Elliptical Lens
	PB Black					4 On/Off	4 Spread Lens
	PW White						5 Spike mounting
	CC Custom						

NL1606	-	-	-	-	-	-	-
--------	---	---	---	---	---	---	---